

# ABS ACTUATOR ON-VEHICLE INSPECTION

BROWS-02

## HINT:

Using the ABS actuator checker (SST), check the operation of the actuator. If the actuator does not operate, check the operation of sub-wire harness G according to the instructions on pages DI-60 and DI-64. If the solenoid and/or pump motor relay are abnormal, replace the relay and inspect the actuator operation again.

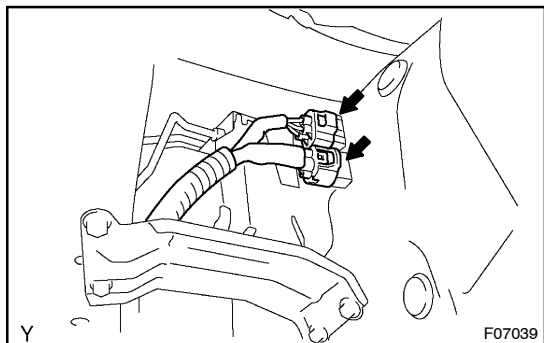

## 1. INSPECT BATTERY VOLTAGE

Battery voltage: 10 - 14 V

## 2. DISCONNECT CONNECTORS

Disconnect 2 connectors from the actuator.

## 3. CONNECT ACTUATOR CHECKER (SST) TO ACTUATOR

- (a) Connect the actuator checker (SST) to the actuator, control relay and body side wire harness through the sub-wire harness G, I and L (SST) as shown.

SST 09990-00150, 09990-00250, 09990-00300, 09990-00360

- (b) Connect the red cable of the checker to the battery positive (+) terminal and black cable to the negative (-) terminal. Connect the black cable of the sub-wire harness to the battery negative (-) terminal or body ground.

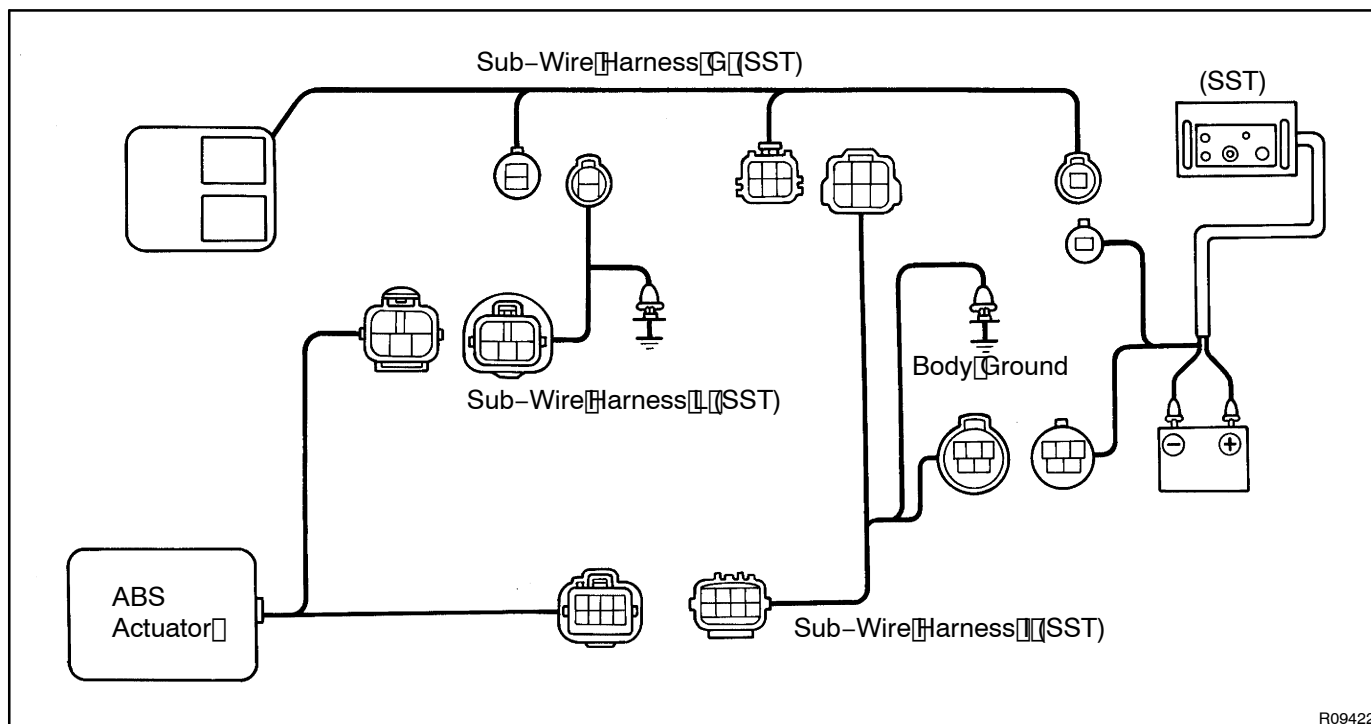

R09422

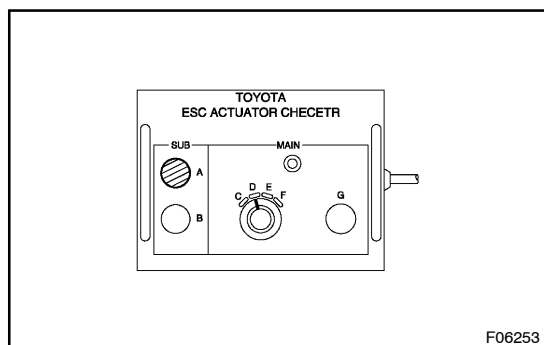

#### 4. INSPECT ABS ACTUATOR OPERATION OF FRONT RH WHEEL

##### HINT:

The functions of the ABS actuator checker switches are shown in the table below.

A	Motor ON/OFF
B	Front LH solenoid ON/OFF
C	-
D	Front RH solenoid
E	-
F	Rear solenoid
G	Solenoid ON/OFF

- Start the engine and run it at idle.
- Turn select switch of the actuator checker to the "D" position.
- Push and hold in the "A" switch for a few seconds. Make sure that you can hear the motor running.

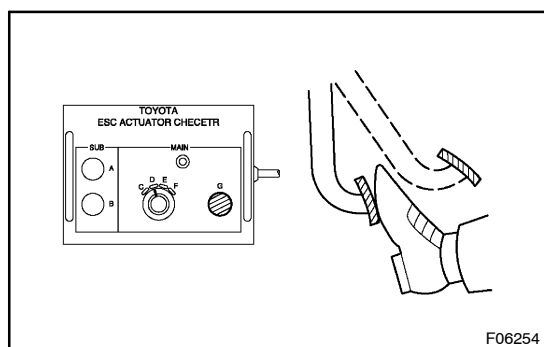

- Depress the brake pedal and hold it until step (g) is completed.
- Push and hold in the "G" switch for a few seconds, and check that the brake pedal does not go down.

##### NOTICE:

**Do not keep the "G" switch pushed down for more than 10 seconds.**

- Release the "G" switch and check that the pedal goes down.

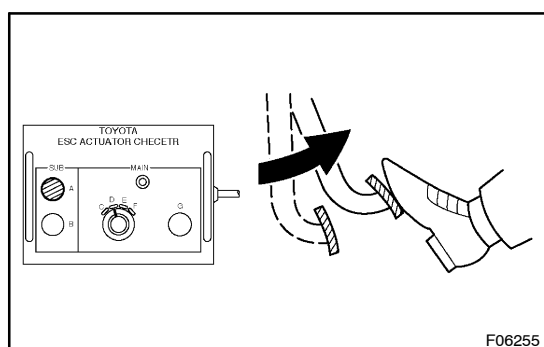

- Push the "A" switch and check that the pedal returns.
- Release the brake pedal.

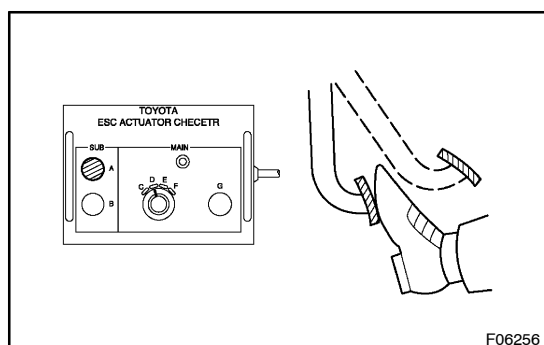

- Push and hold in the "A" switch for a few seconds.
- Depress the brake pedal and hold it for about 15 seconds. As you hold the pedal down, push the "A" switch for a few seconds and check that the brake pedal does not pulsate.
- Release the brake pedal.

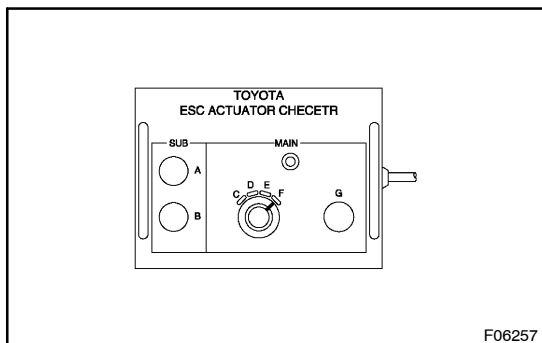

## 5. INSPECT FOR REAR WHEEL

- Tun the select switch to the "F" position.
- Repeat (d) to (k) of the step 4, checking the actuator operation similarly.

## 6. INSPECT FOR FRONT LH WHEEL

### HINT:

Push the "B" switch instead of the "G" switch, and inspect it in any selector switch position.

- Push and hold "A" switch for a few seconds.

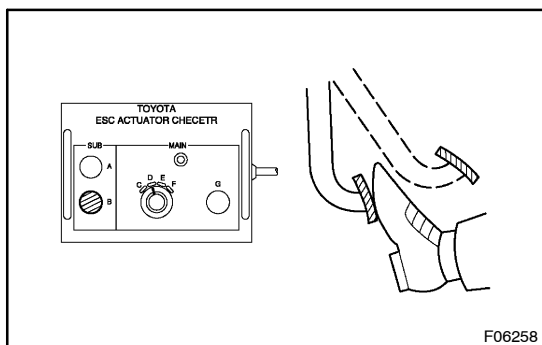

- Depress the brake pedal and hold it until step (e) is completed.
- Push and hold in the "B" switch for a few seconds, and check that the brake pedal does not go down.

### NOTICE:

**Do not keep the "B" switch pushed down for more than 10 seconds.**

- Release the "B" switch and check that the pedal goes down.

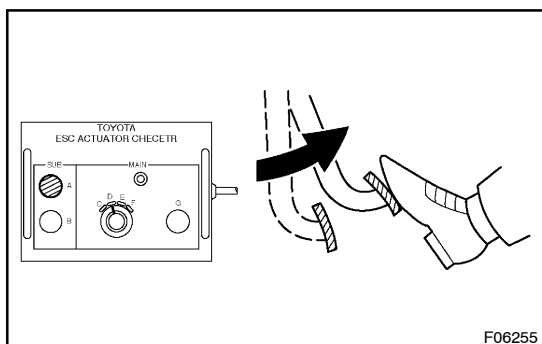

- Push the "A" switch and check that the pedal returns.
- Release the brake pedal.

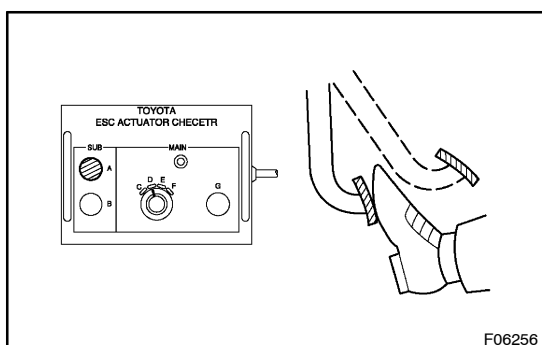

- Push and hold in the "A" switch for a few seconds.
- Depress the brake pedal and hold it for about 15 seconds. As you hold the pedal down, push the "A" switch for a few seconds and check that the brake pedal does not pulsate.
- Release the brake pedal.

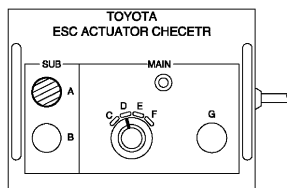

F06253

**7. PUSH "A" SWITCH**

- (a) Push and hold in the "A" switch for a few seconds.
- (b) Stop the engine.

**8. DISCONNECT ACTUATOR CHECKER (SST) FROM ACTUATOR**

Disconnect the actuator checker (SST) and 3 sub-wire harness (SST) from the actuator.

SST 09990-00150, 09990-00250, 09990-00300,  
09990-00360

**9. CONNECT CONNECTORS**

Connect 2 connectors to the actuator.

**10. CLEAR DTC (See page DI-52)**